

SPECIFICATIONS

Capacity:.....350 Lbs.

Maximum Drawer Capacity:22 Lbs.

Overall Dimensions:.....26-3/8 x 14-1/8 x 16"

Side tool tray maximum capacity:.....11 Lbs.

This product is designed to support a maximum capacity of 159 kg, including all tools and equipment. It is intended to be used to support and transport, along a smooth and level surface. This product is not intended, designed or engineered to be used for any other purpose.

Specifications are subject to change without notice

IMPORTANT SAFETY INFORMATION

▲ WARNING! READ, UNDERSTAND AND FOLLOW ALL INSTRUCTIONS, AND WARNINGS BEFORE OPERATING THIS TOOL. FAILURE TO DO SO MAY RESULT IN PERSONAL INJURY AND/OR PROPERTY DAMAGE AND WILL VOID WARRANTY.

PARTS DIAGRAM

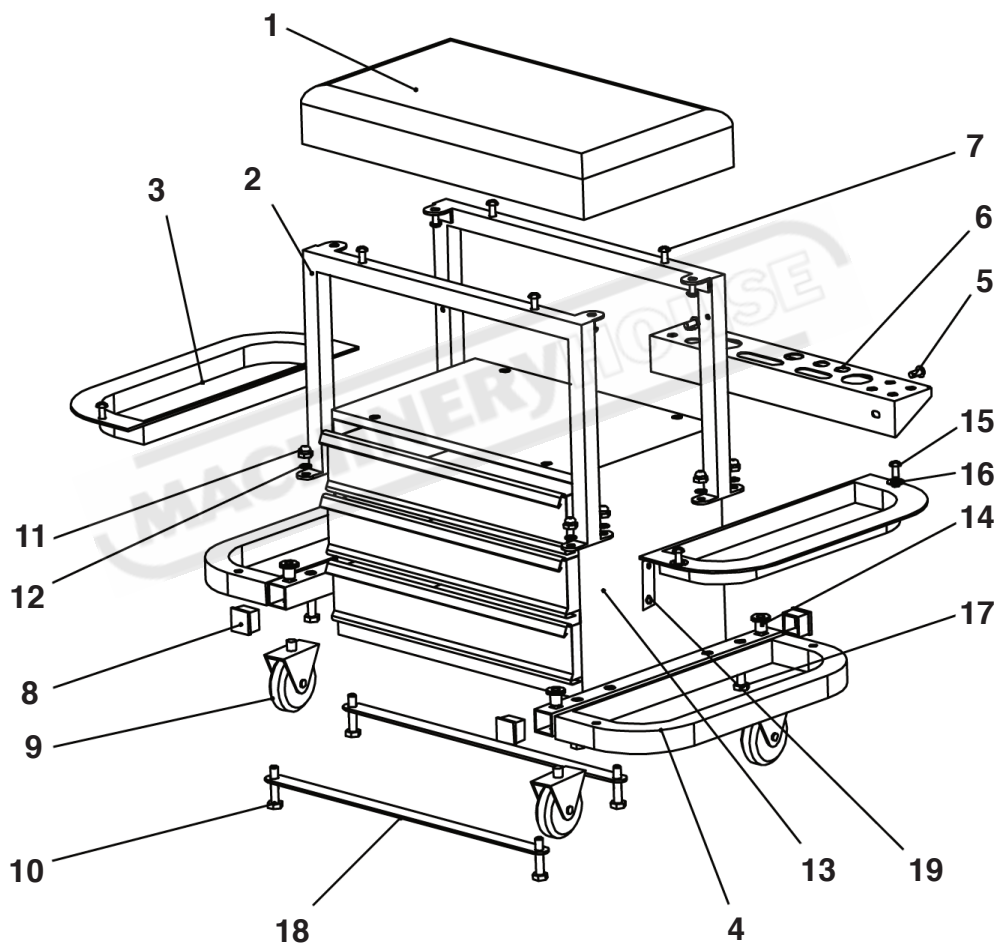

PARTS LISTING

No.	Description	Qty.	No.	Description	Qty.	No.	Description	Qty.
1	Stool Pad	1	8	Plastic Tube Cap	4	14	Sleeve Nut	4
2	Body Frame	2	9	2.5" PVC Caster	4	15	Bolt M8x16	4
3	Plastic Tray	2	10	Bolt M8x40	4	16	Washer 8	4
4	Side tray frame	2	11	Nut M8	8	17	Bolt M8x35	4
5	Bolt M6x10	2	12	Washer 8	8	18	Support Bar	2
6	Tool Holder Shelf	1	13	Body with 3 Drawers	1	19	Buckle	2
7	Bolt M6x30	8						